









LEGENDE

-  Feuerwehrzufahrt
-  Weg zur BMZ
-  BMZ
-  FBF
-  FSK
-  Unterflurhydrant
-  befahrbare Fläche
-  PKW-Stellfläche
-  Gebäudehaupteingang



20m
20m

BORSTELER TRIFT

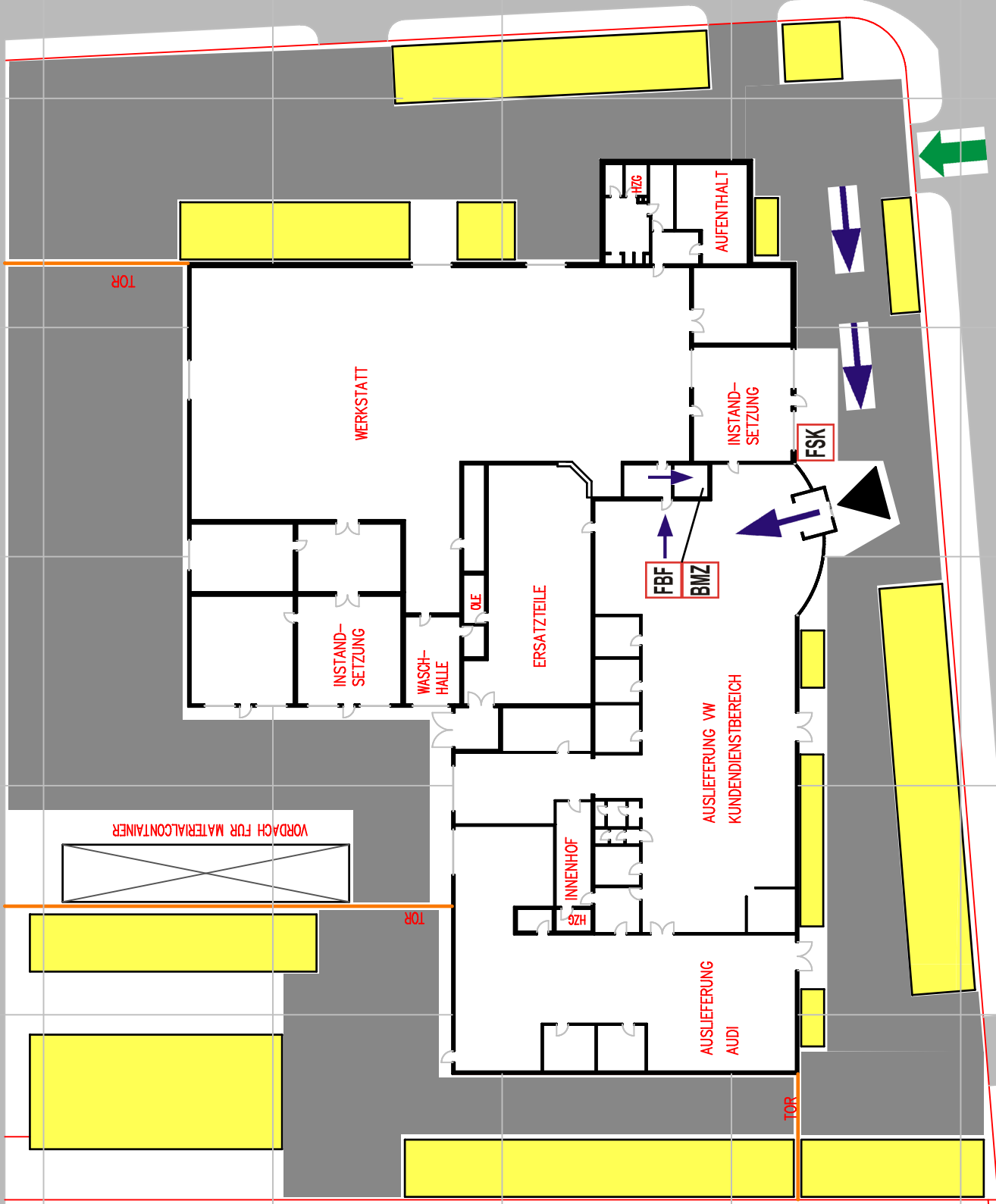

BORSTELER DORFSTRASSE

GEBRAUCHTWAGENGELÄNDE

VAG Autohaus Eggers
Hermann Eggers GmbH & Co.KG
 Borsteler Dorfstraße 102, 27283 Verden - Borstel

Übersichtsplan - Betriebsgelände

M.: 1:500 Datum: 7.7.2006 Gez.: D.Laporte
 HETMA Brandschutz GmbH Stubbener Str. 50 27721 Ritterhude
 Tel.: 0421 - 637450 Fax: 6362556 Internet: www.hetma.de E-mail: info@hetma.de